



CPS-Cleaning Systems | SCBA-Training Facility | SCBA-Workshops

MAW

Founded in 1996

Special provider for

- CPS-Cleaning Systems
- SCBA-Training Facilities
- SCBA-Workshops

Supplier for

- Metal and plant construction
- Special solutions

From the planning to the installation –
all from a single source.



A white sign with a red border and a red banner at the bottom. It features the MAW logo and the text 'Metallbau Anlagenbau Werkstätten'. Below the logo, the contact information is listed: 'Tel.: 0 79 04 / 94 377 - 0' and 'Fax: 0 79 04 / 94 377 - 77'. The website 'www.mawonline.de' is printed in white on the red banner. The sign is positioned in front of a bush of pink roses.



CPS- Cleaning Systems

Patented systems for cleaning,
disinfection and drying

Variable and selectable cleaning time
and procedure

Unified cleaning system (cleaning,
disinfection, washing, rinsing, drying)

High quality stainless steel construction

Quality assurance and certification



CPS – Cleaning Systems

This state of the art Chemical Protection Suit Cleaning System provides for first quality comprehensive cleaning including disinfection and drying.

This leads to the best cleaning results of your equipment such as respiratory protection masks, breathing regulators or CPS of all types at low personnel costs.

- Self-explanatory menu navigation, easy programme selection
- Stainless steel (1.4301)
- Fully automatic dosing with level control
- Separate discharge of waste water possible
- Constant ventilation of washing room
- Side Channel Blower with heater for fast drying
- Remote-access online maintenance possible



Modern, user-friendly touch-screen control panels



CPS-Cleaning Systems are available in single and double versions



High quality Coupling Systems

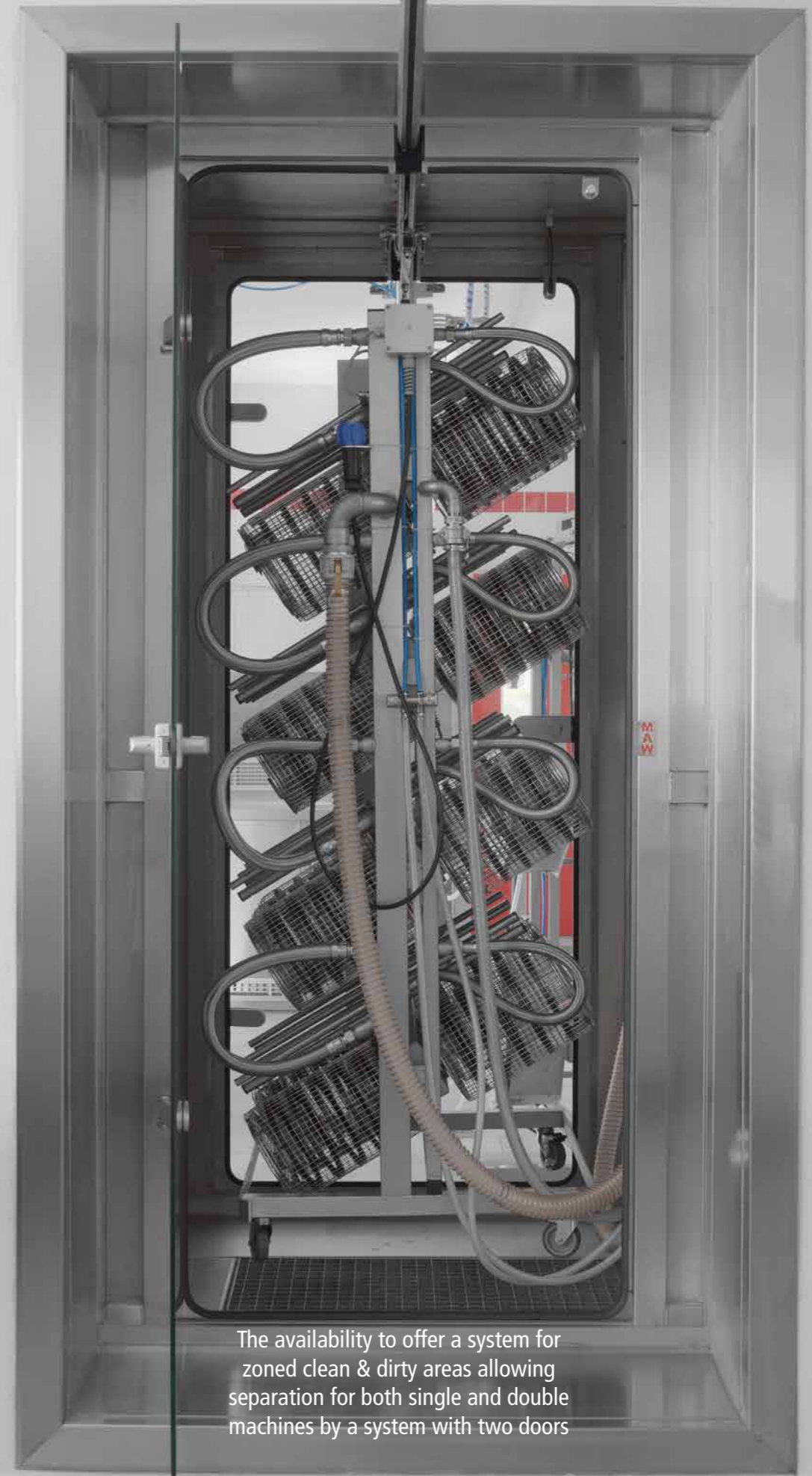

The availability to offer a system for zoned clean & dirty areas allowing separation for both single and double machines by a system with two doors

CPS

Patented cleaning systems for the cleaning of respiratory masks, breathing regulators, compressed air breathing apparatuses, helmets, chemical protection suits as well as combination modules make for our individuality. Thanks to the fully automatic cleaning system, personnel capacity can be applied specifically.

Cleaning Module for Chemical Protection Suit

(Art. No. 74.50.11.00)

- For fully automatic procedure of all cleaning processes for CPS (rinsing, cleaning, disinfection, drying)
- Seawater resistant anodized aluminum frame for protective clothing which is air-steamed for optimal cleaning and prevention of wrinkles



Cleaning Module for Respiratory Protection Masks

(Art. No. 74.50.05.24)

- For fully automatic procedure of all cleaning processes for up to 24 protection masks (rinsing, cleaning, disinfection, drying)
- For different types of masks
- Cleaning without mechanical stress through rotating and swinging movement of the baskets
- Entirely stainless steel, also connectable to ceiling rail system



Cleaning Module for Breathing Regulators

(Art. No. 74.50.07.00)

- For fully automatic procedure of all cleaning processes for up to 32 breathing regulators (rinsing, cleaning, disinfection, drying)
- 4 rotating receptacles with 8 flexible cleaning spaces for breathing regulators
- Entirely stainless steel, also connectable to ceiling rail system



CPS

Cleaning Module for Compressed Air Breathing Apparatuses

(Art. Nr. 74.50.06.00)

- For fully automatic procedure of all cleaning processes for up to 6 compressed air breathing apparatuses simultaneously (rinsing, cleaning, disinfection, drying)
- 2 vertical cleaning levels with 4 motor-driven rotating washing frames
- Including 6 compressed air bottles at 0.36 l each
- Packing units for manometer and electric attachment parts
- Entirely stainless steel, also connectable to ceiling rail system



Cleaning Combi-Module for Respiratory Protection Masks and Breathing Regulators

(Art. Nr. 74.50.05.02)

- Fully automated procedure of all cleaning processes for up to 12 protection masks and 16 breathing regulators (rinsing, cleaning, disinfection, drying)
- This alternative module is a perfect combination to the single version of masks and regulators offering maximum flexibility for a user that has low throughput
- Cleaning without mechanical stress through rotating and swinging movement of the baskets
- Built entirely from stainless steel and connectable to a ceiling rail system



CPS

Cleaning Module for Helmets (Art. No. 74.50.07.50)

- For fully automatic procedure of all cleaning processes for up to 16 helmets simultaneously (rinsing, cleaning, disinfection, drying)
- 1 motor-driven washing frame with one spray lance per level
- Entirely stainless steel, also connectable to ceiling rail system



Portable CPS Unit (Art. No. 74.55.01.01)

- For the storage and transportation of 2 Chemical Protection Suits
- Hydraulic height adjustment via local foot pump
- Entirely stainless steel
- Transfer feature for ceiling rail system and for connection directly to CPS-Station



CPS DOUBLE VERSION passage system
for clean and dirty separation

SCBA Workshop

Individual development of your respiratory protection workshop

Resistant and durable quality furniture constructed from different materials

Effective organization of workplaces

One-off production runs

Optimal solutions

Long history of installation experience



Stainless steel sink facility with extraction of the basin and the base area



Individual solutions for supply of breathing air and reducing stations for the workshop area

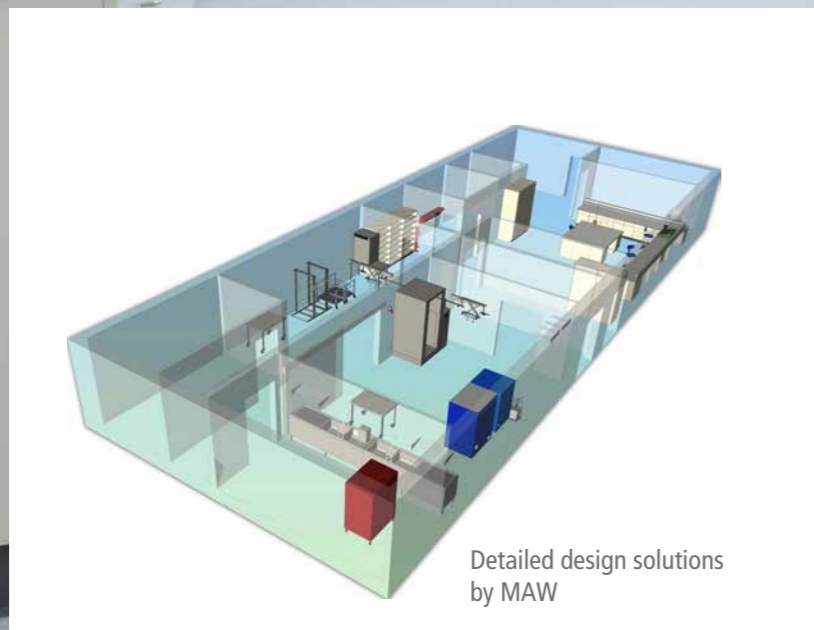

Detailed design solutions by MAW



High-quality special solutions according to customer specifications

SCBA-Training Facilities

Suitable for stress and operation exercises

Modular construction

Individually changeable – almost without tools

Up-to-date monitoring technology - different versions available

State of the art control technology for maximum training security

Stationary and mobile versions

Security by RFID technology in connection with the monitoring of Vital functions

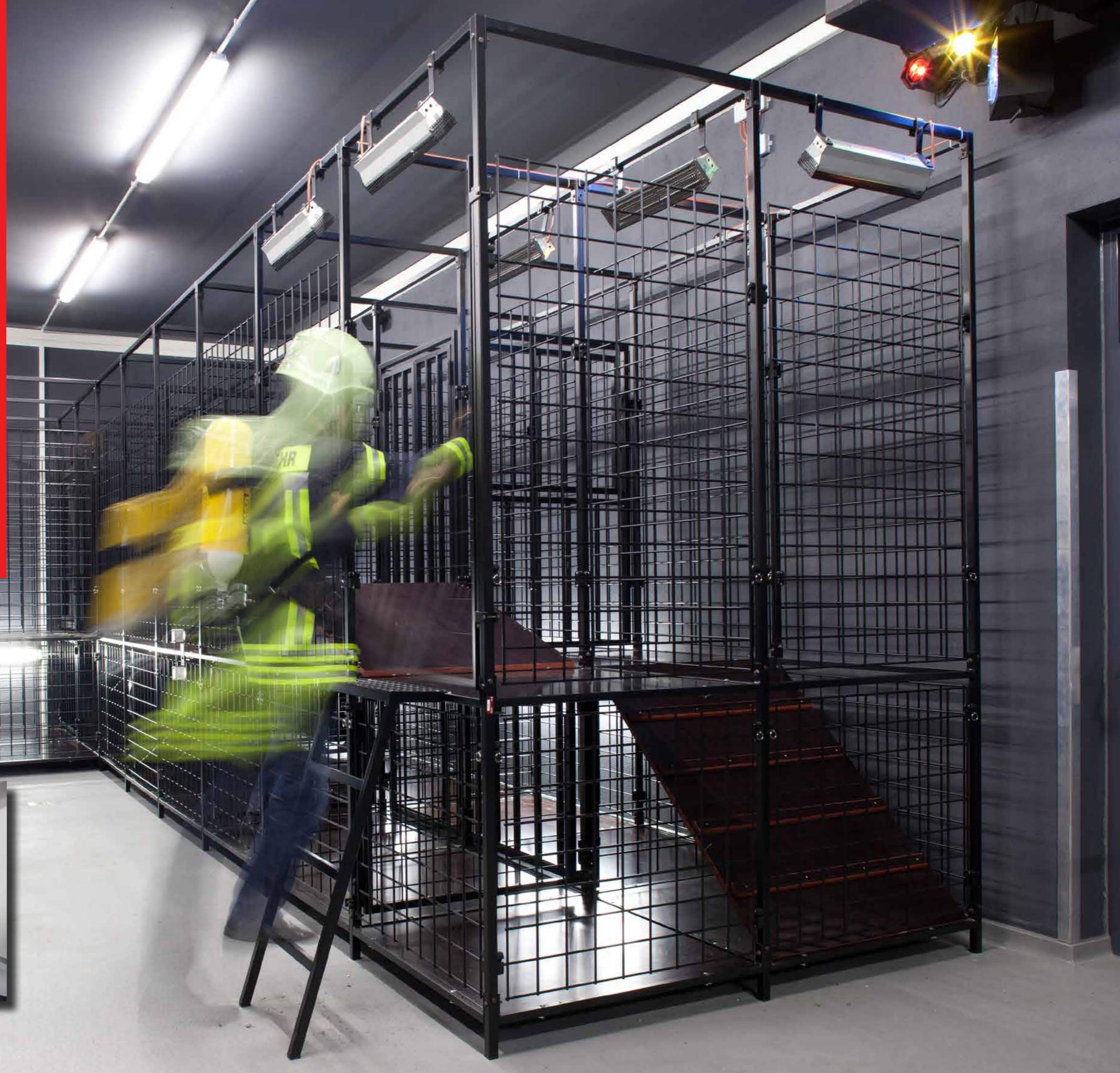

SCBA-Training Facilities

Process Control Station (Art. No. 100.0901.0100)

The core of respiratory protection training facilities is the control room. Our process control station outperforms your expectations.

Innovative technology controls the training processes with the utmost possible security for the trainee as well as for the instructor.

The intelligent, network-compatible ASÜS software by MAW manages training participants, exercises and controllers confidently at minimal personnel costs.

The ASÜS software was developed in cooperation with fire brigades and successfully tested long before its launch. We are more than happy to convince you of the results of our new development.

Progress in this area has been shaped significantly throughout the years by MAW. This was achieved by innovations such as the market launch of the monitoring technology RFID or touch-PC controls and other monitoring technology, as well as our membership of the **DIN** work group for respiratory protection training facilities.

The monitoring of the participants' vital parameters during the exercises increases the quality and security for the user.

Exercise records are documented and saved by means of the most modern technology, printed if needed and sent directly to the accounting centre.

Thanks to this innovation, personnel reduction, energy and time savings at respiratory protection training facilities by MAW are not achieved without putting safety at risk.

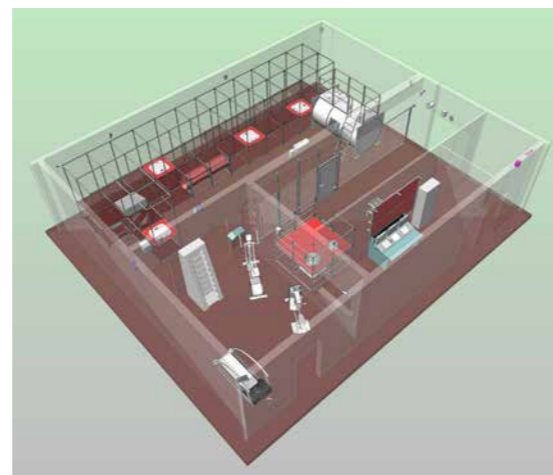
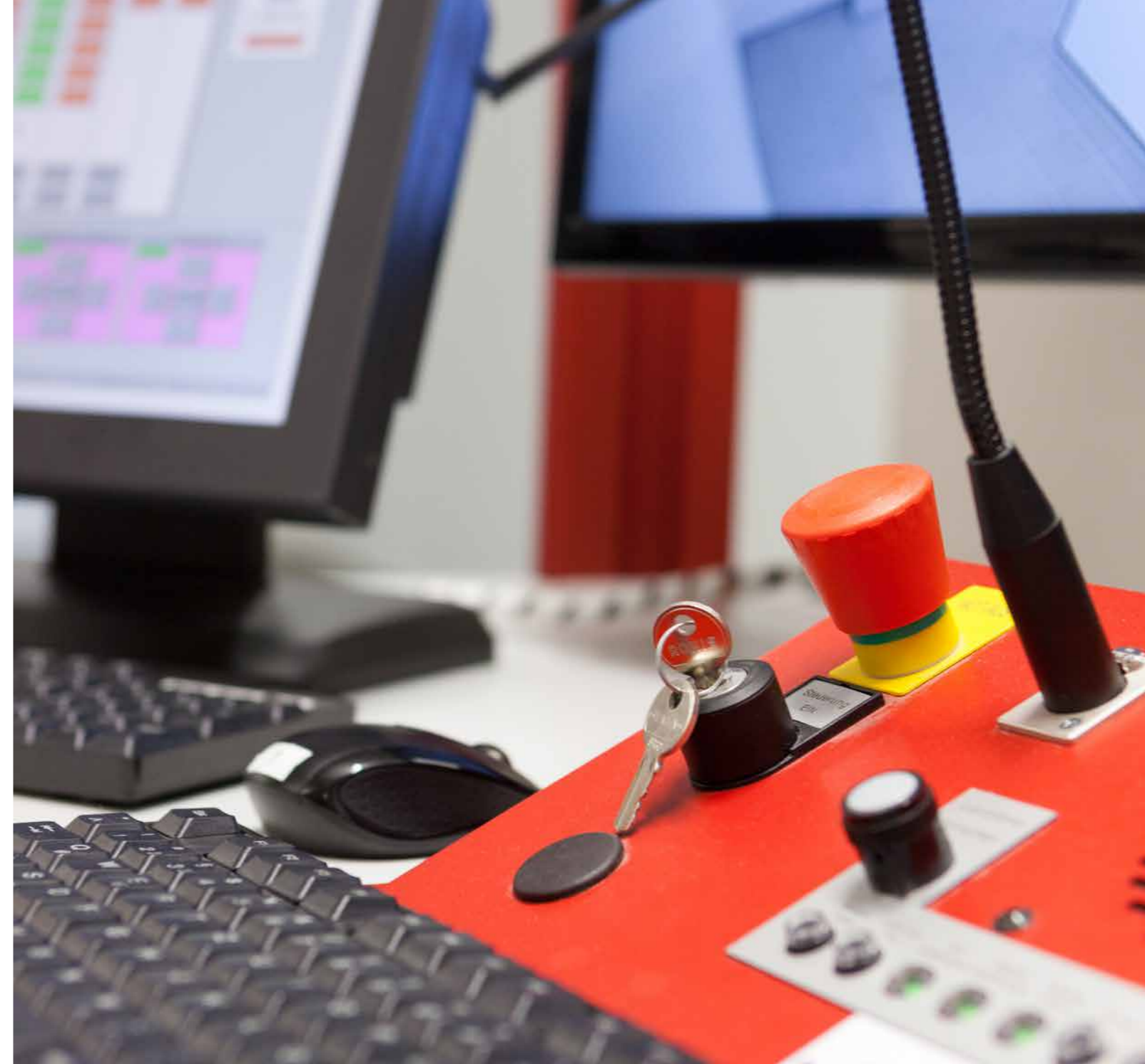

SCBA-Training Facilities

We not only promise individual solutions but we also achieve them. Within the shortest time possible we can build a respiratory protection training course suitable for your premises and in accordance with your needs.

Sealing bag facilities, pipeline facilities, "hot doors", or customized special solutions are made in our own company, so that we can respond to your requests in a flexible and fast way.

Tank (Art. No. 06.01.00.00)

For entering small spaces such as narrow containers or shafts as well as for searching persons and underground rescues according to **DIN**.

Breaking Door (Art. No. 100.04.11.01)

Exercise door for the training and handling of the halligan tool for interior and exterior fire fights and for the cooperation within the group training.



SCBA-Training Facilities

Endless ladder (Art. Nr. 100.01.02.03)

- Used to exercise trainees prior to entering the training-gallery
- Durable and robust, offering various protection-systems
- Selection of control systems are available
- Can also be used as a standalone exercise machine

Truck training facility (Art. Nr. 100.07.40.00)

- For practical recovery training of hazardous substances
- Used as a tool for further CPS-training

Impact hammer (Art. Nr. 100.01.01.01)

- Robust work out machine with a lifting-weight of 18 kg
- Used for many years in training facilities
- Selection of control systems are available

Thermal imaging camera (Art. Nr. 100.09.06.01)

- Used for thermal visual control within training facilities
- Mounted Fixed or on motorised head to control remotely
- Light and compact version
- High picture quality



Innovative Special Solutions

SCBA-Training Facility using Round Pipes

This is meant to simulate an underground tunnel environment with open shafts, with a partial water level and vertical guidance into the next level.

It was installed by MAW in Hong Kong.

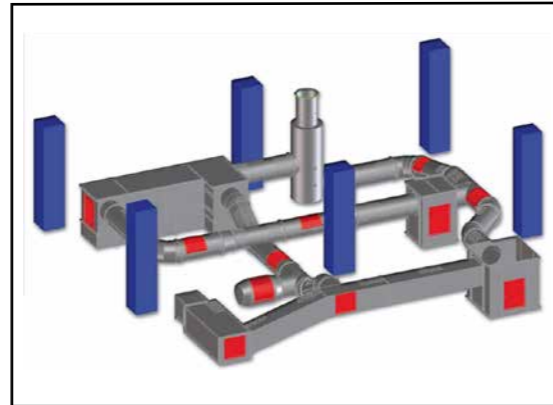

Rescue and Training Facility for Refinery and Column

This is a 3-floor facility with interchangeable floors.

It was installed by MAW in Vienna.

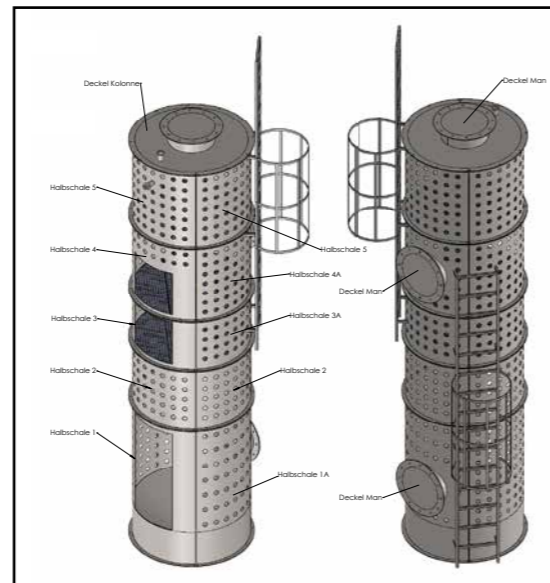

Mobas, Mobile SCBA-Training Facility

This truck trailer can be extended sideways and contains a training unit of 45 meters with 8 working machines.

It was installed by MAW in Berlin.



"Hot Door"
(Art. No. 100.19.02.0200)

Completely made of stainless steel 1.4031.
Heatable up to 250°C, extinguishable and
possible to manipulate various ways of opening.

Our Service – Your Security

Our experienced team supports you from the first assessment through the planning, installation and process to the supervision and after sales service within the scopes of respiratory protection.

On request, we are also happy to maintain and modernize other companies' facilities.

You will find our facilities on 4 continents. These facilities are installed and maintained exclusively by MAW.

Our production area of nearly 3,500 m² with its own electronic department does not employ any subcontractors. Therefore you, our customer, will always find the right expert for your inquiries.

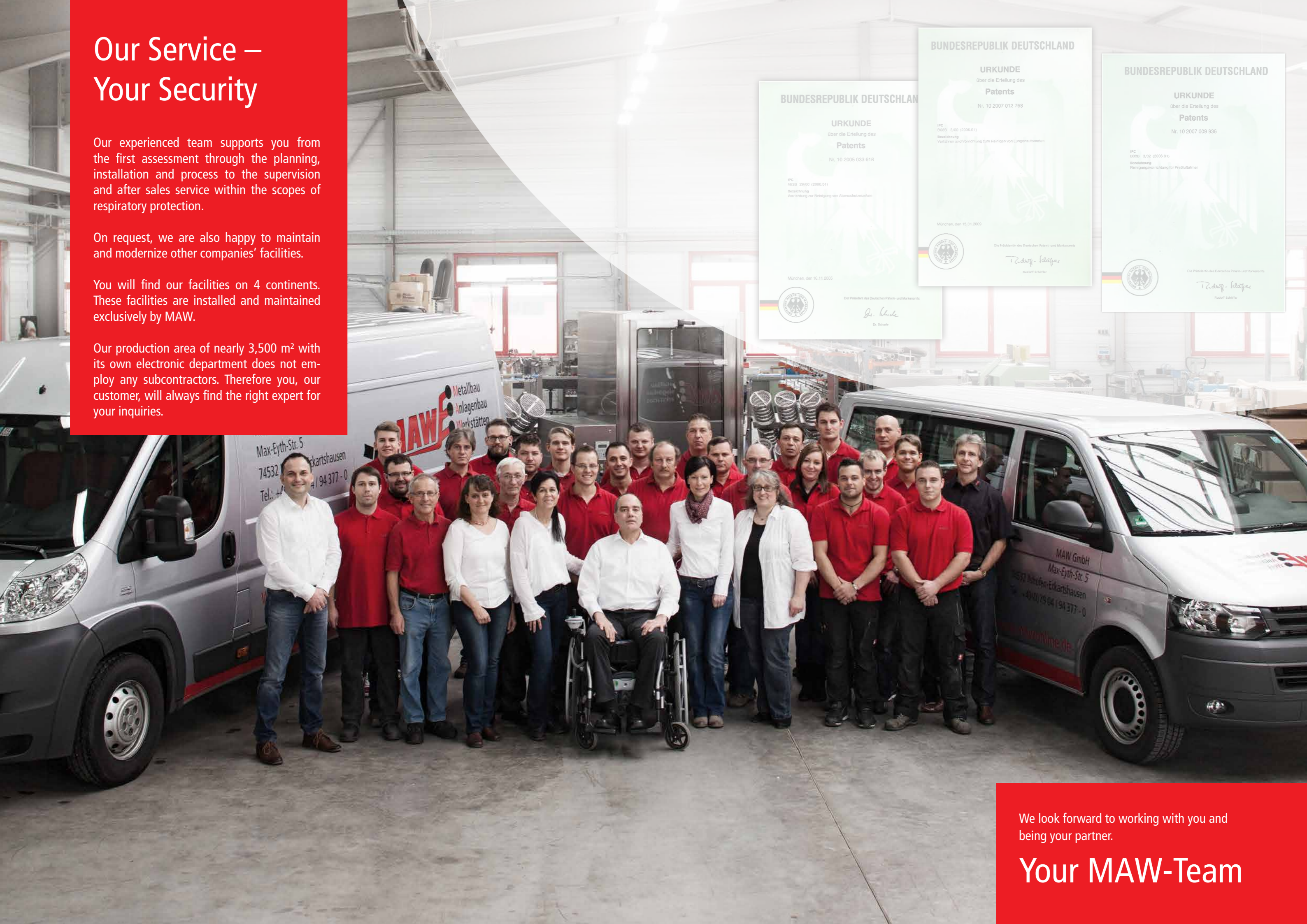
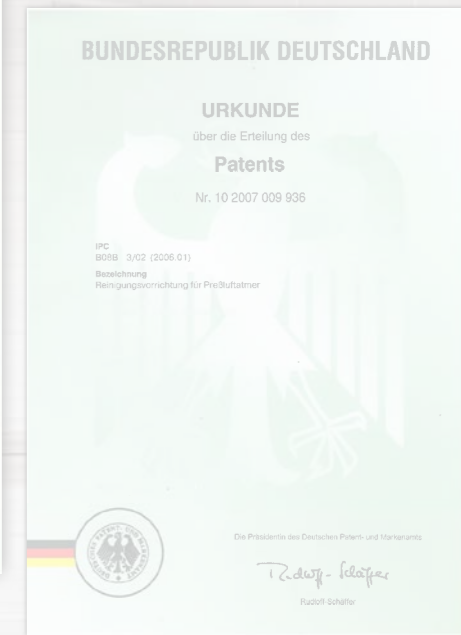
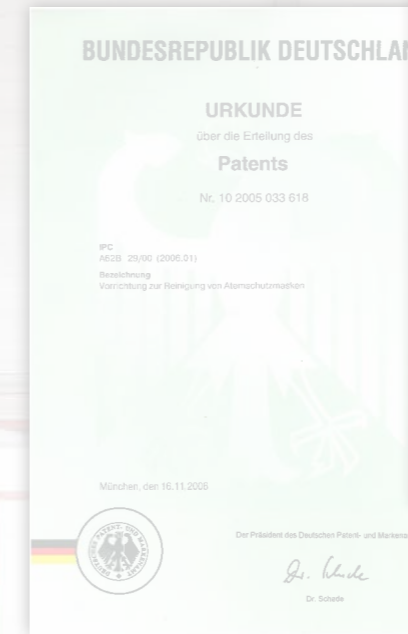

We look forward to working with you and being your partner.
Your MAW-Team



MAW GmbH
Max-Eyth-Str. 5
D-74532 Ilshofen-Eckartshausen

Tel.: +49(0) 79 04 / 94 377 - 0
Fax: +49(0) 79 04 / 94 377 - 77

info@mawonline.de
www.mawonline.de